

ONE COMPONENT LIGHT CURED UNIVERSAL ADHESIVE

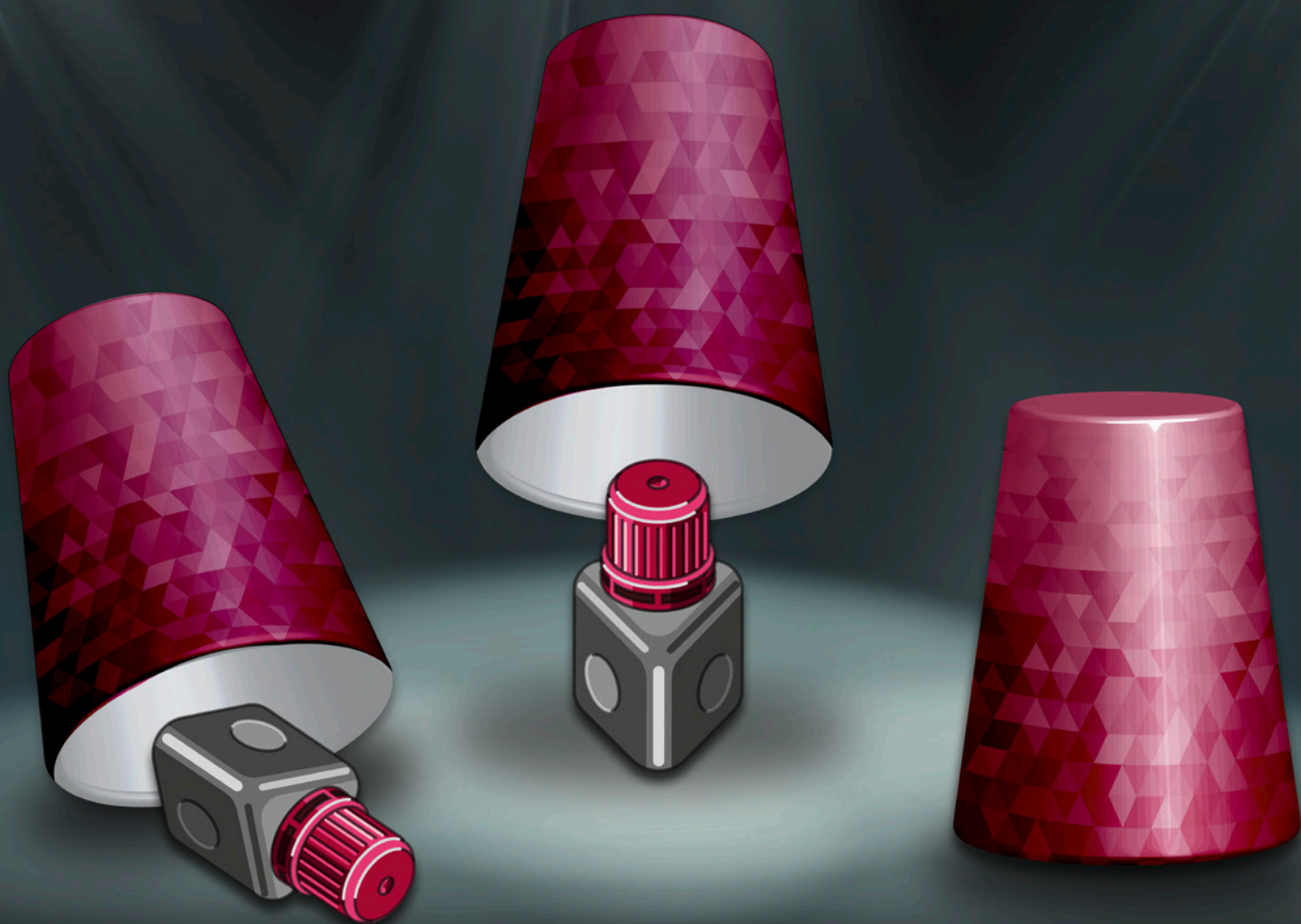

# ALWAYS THE RIGHT CHOICE

**ONE COAT 7 UNIVERSAL**

All-in-one

 **COLTENE**

# Dosage forms

## New and unique bottle

The new ergonomic bottle with optimised dropper is distinguished by precise, clean dispensing without continued flow.

- Up to 300 applications\*
- Simplified handling
- Ergonomic



## Practical Single Dose

ONE COAT 7 UNIVERSAL is available as practical single dose for hygienic single use application. For easy, all-round efficient performance in daily practice routine.

- User-friendly
- Easy application
- Hygienic



\* Source: internal data

# The all-rounder

## One bond for all application techniques

- Exceptional bonding values on enamel and dentine
- Excellent marginal seal
- Minimised postoperative sensitivity

With the system optimisation of ONE COAT 7.0 , the reliable all-in-one bond ONE COAT 7 UNIVERSAL is now available for every indication.

## The magic triangle

No matter whether Self-Etch, Total Etch or Selective Etch, ONE COAT 7 UNIVERSAL covers all needs. Effortless bonding to materials such as gold, titanium, ceramics, zirconium oxide and composite entirely without additional primer or silane.

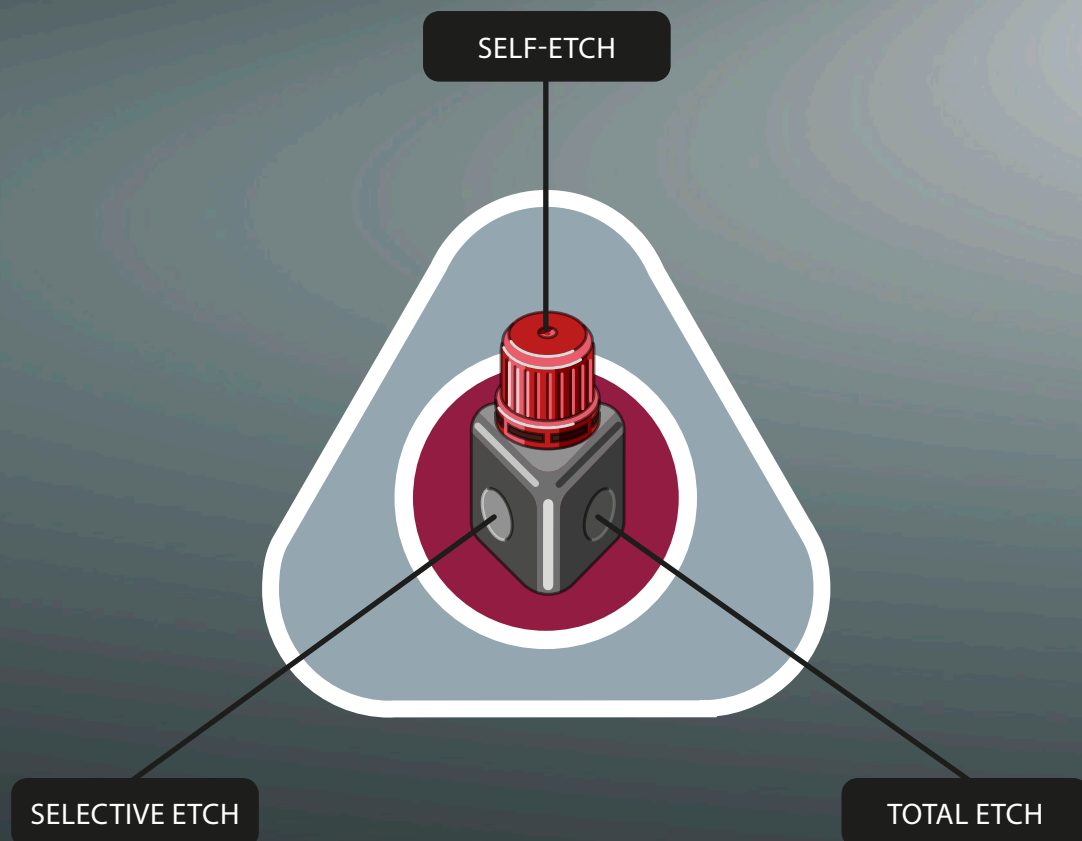

# Technical data

## The test method

The graphs represent the shear bonding strength (SBS/MPa) according to Watanabe. High bonding strengths are indicative of a good substance between bonding agent and tooth material. This is crucial for the good bond of dental restorations.

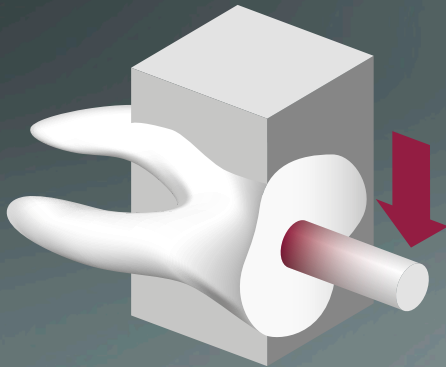

Schematic representation SBS

## Comparison of shear bonding strength (SBS/MPa) using the Self-Etch technique

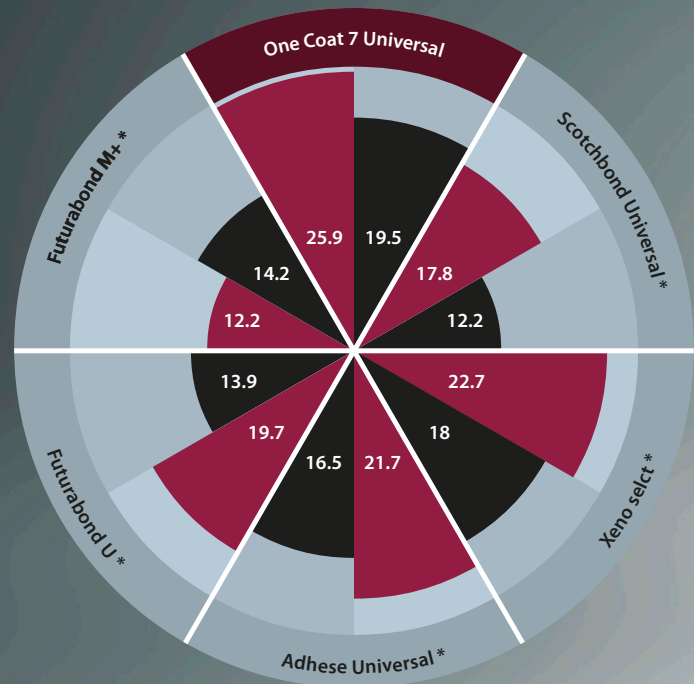

## Comparison of shear bonding strength (SBS/MPa) using the Total Etch technique

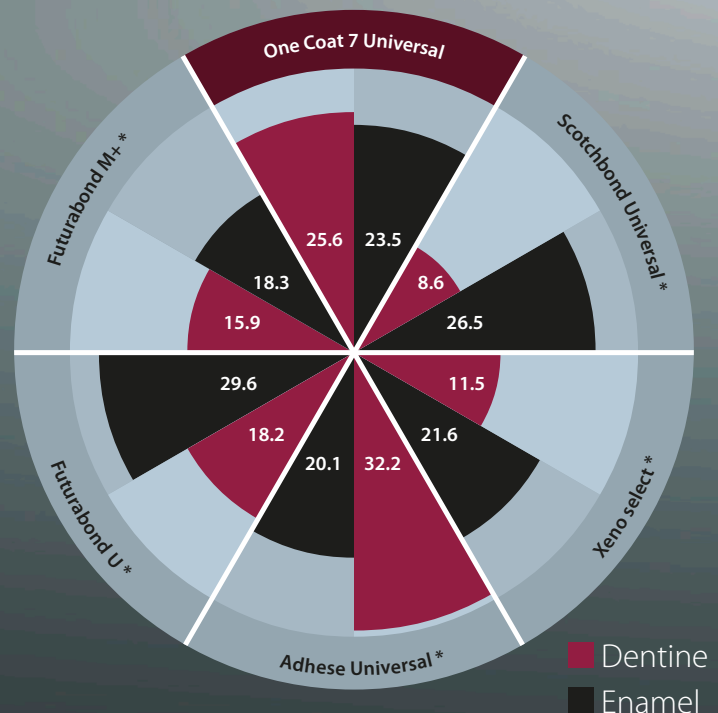

# Properties

## Antibacterial\*

ONE COAT 7 UNIVERSAL has been tested for its antibacterial\* effect.



\*Testing with proliferation test for antimicrobial activity with *S.epidermidis* by QualityLabs, Germany.

## Chemical curing

The special One Coat 7.0 Activator ensures compatibility with chemically curing materials.



**ONE COAT 7 UNIVERSAL**  
contains:



\*Methacryloyl-oxydecyl-dihydrogenphosphat

# Order information



## **60019538 ONE COAT 7 UNIVERSAL Intro Kit**

1 × 5 ml One Coat 7 Universal  
 1 × 2.5 ml Etchant Gel S  
 1 × 20 Application tips  
 1 × 50 Brushes black  
 1 × Mixing well  
 1 × Cover for mixing well



## **7054 ONE COAT 7.0 Activator Kit**

1 × 3 ml One Coat 7.0 Activator  
 1 × 50 Brushes black

## **60019539 ONE COAT 7 UNIVERSAL Refill**

1 × 5 ml One Coat 7 Universal

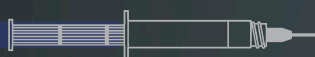

## **7373 Etchant Gel S Kit**

2 × 2.5 ml Syringe  
 1 × 20 Application tips

## **60019540 ONE COAT 7 UNIVERSAL Single Dose**

50 × 0.1 ml One Coat 7 Universal Single Dose  
 1 × 50 Brushes black

## **7634 Brushes black**

1 × 50 Brushes black



© 2016 Coltène/Whaledent AG  
[www.coltene.com](http://www.coltene.com) | [oc7universal.coltene.com](http://oc7universal.coltene.com)

**Coltène/Whaledent AG**  
 Feldwiesenstrasse 20  
 9450 Altstätten / Switzerland  
 T +41 71 757 53 00  
 F +41 71 757 53 01  
[info.ch@coltene.com](mailto:info.ch@coltene.com)

**Coltène/Whaledent Ltd.**  
 The President Suite  
 Kendal House, Victoria Way  
 Burgess Hill, West Sussex  
 RH15 9NF / UK  
 T +44 1444 235486  
 F +44 1444 870640  
[info.uk@coltene.com](mailto:info.uk@coltene.com)

**Coltène/Whaledent Inc.**  
 235 Ascot Parkway  
 Cuyahoga Falls, Ohio 44223 / USA  
 T +1 330 916 8800  
 F +1 330 916 7077  
[info.us@coltene.com](mailto:info.us@coltene.com)



**COLTENE**